

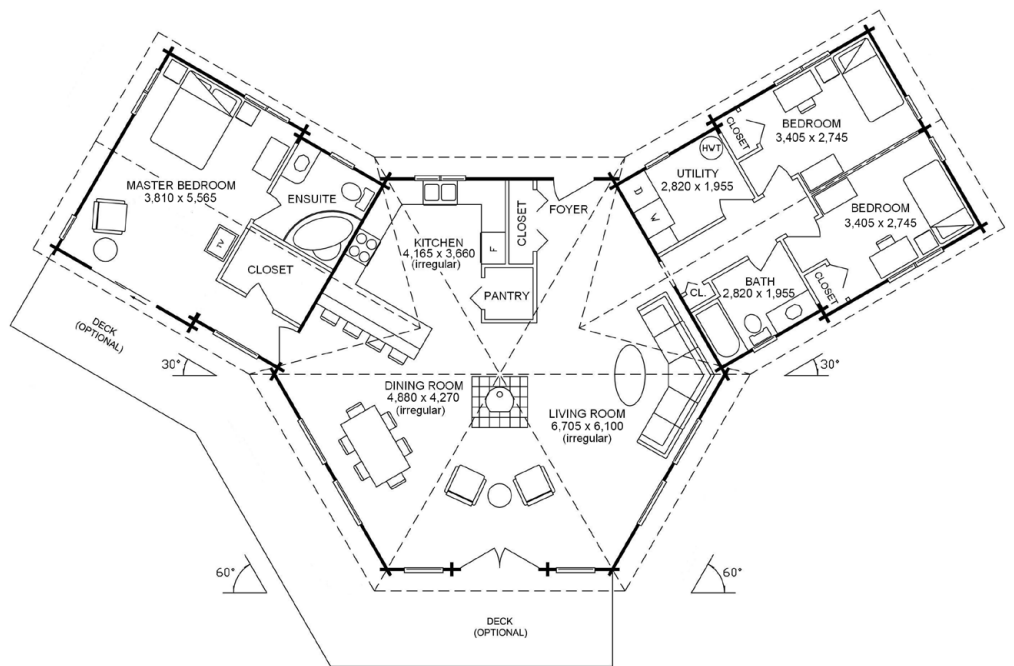

Denman

The Denman offers an exciting hexagonal floor plan with expansive Great Room encompassing kitchen, dining and living areas under a vaulted open beam cathedral ceiling, surrounded by glass and centered on an open fireplace. Wings on either side of the Great Room contain a Master Bedroom with bathroom and a two bedroom plus bathroom combination respectively.



MAIN FLOOR
161.21 m² (48.77 坪)

Floor Plan:

Denman

Model No:

5817

Total Area:

161.21 m² (48.77 坪)

Width:

23.49 m

Depth:

13.8 m

