



Montana

This spacious four-bedroom, two and a half bathroom floor plan features nine-foot ceilings throughout, an open design which includes vaulted ceilings in the Great Room and an oversized kitchen area with pantry. Its large size and open concept make it the perfect family home or vacation getaway to be shared with your friends.

Floor Plan:

Montana

Model No:

5020

Total Area:

208.37 m² (63.03 坪)

Width:

16.0 m

Depth:

12.0 m

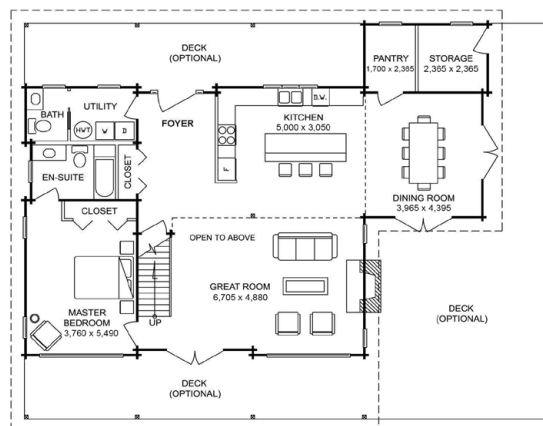

MAIN FLOOR
142.06 m² (42.97 坪)

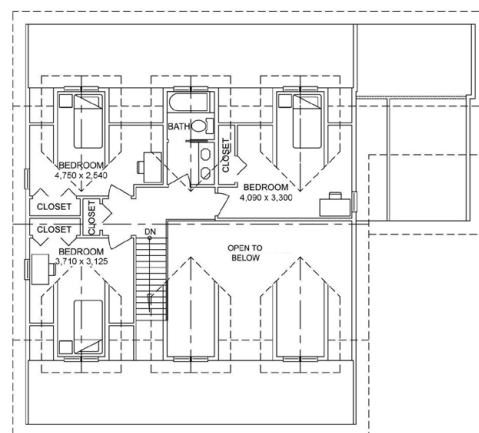

UPPER FLOOR
66.31 m² (20.06 坪)

