



# Vermont

An elegant home distinguished by vast areas of glass and expansive decks. The spacious gourmet kitchen features a large eating nook and Family Room. The Master Bedroom includes a bathroom and walk-in closet with French doors leading onto a deck or garden setting. Formal living and dining rooms, two bedrooms on the upper level and a grand entrance make the Vermont a spectacular place to call home.

Floor Plan:

**Vermont**

Model No:

**2001**

Total Area:

**216.33 m<sup>2</sup> (65.44 坪)**

Width:

**17.57 m**

Depth:

**12.65 m**

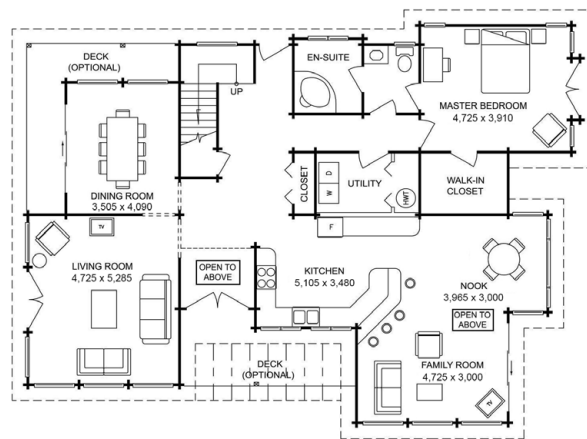

MAIN FLOOR  
164.51 m<sup>2</sup> (49.77 坪)

UPPER FLOOR  
51.82 m<sup>2</sup> (15.67 坪)

